



Road Running Technical Council  
USA Track & Field

Measurement Certificate



Name of the course The Rowley 5K Distance 5 km

Location (state) NY (city) Middletown

Type of course: road race  calibration  track  Configuration: partial loop

Type of surface: paved \_\_\_\_\_ % dirt \_\_\_\_\_ % gravel \_\_\_\_\_ % grass \_\_\_\_\_ % track \_\_\_\_\_ %

Elevation (feet above sea level) Start 552 Finish 536 Highest 561 Lowest 522

Straight line distance between start & finish 614 Drop 1.0 m/km Separation 3.7 %

Measured by (name, address, phone & e-mail) William G. Norton, PLS, 110 Sarine Rd.,  
Wurtsboro, NY 12790; 845-888-2107; wgn@frontiernet.net

Race contact (name, address & phone) Frank Gianino, 809 211E, Middletown, NY 10941;  
845-692-9225

Measuring Methods: bicycle  steel tape  electronic distance meter

Number of measurements of entire course: 2 Date(s) when course measured: April 17 & May 19, 2009

Race date: June 14, 2009 Course certification effective date: May 19, 2009

Replaces: NY08012JG (if applicable) Certification code: NY09016JG

Notice to Race Director  
Use this Certification Code in *all* public  
announcements relating to your race.

Be It Officially Noted That

Based on examination of data provided by the above named measurer, the course described above and in the map attached is hereby certified as reasonably accurate in measurement according to the standards adopted by the Road Running Technical Council. If *any* changes are made to the course, this certification becomes void, and the course must then be recertified.

*Validation of Course* — In the event a National Open Record is set on this course, or at the discretion of USA Track & Field, a validation remeasurement may be required to be performed by a member of the Road Running Technical Council. If such a remeasurement shows the course to be short, then all pending records will be rejected and the course certification will be cancelled.

This certification expires on December 31 in the year 2019

AS NATIONALLY CERTIFIED BY:

James A. Gilmer Date: May 29, 2009  
James A. Gilmer, USATF/RRTC Regional Certifier, New York  
232 Van Wies Point Rd., Glenmont, NY 12077 • 518-427-9374 • jagilmer@nycap.rr.com

# The Rowley 5K

June 14, 2009

Map & Course Certification By: William G. Norton  
Professional Land Surveyor

**CERTIFICATION #**  
Indicates Measured Route



**Certified Course**  
NY-09016-JG  
Effective: 5/1/2009  
through 12/31/2019

**KEY POINT LOCATIONS**

**START LINE:** A MAG NAIL PAINTED GREEN SET NEAR THE CENTERLINE OF 16 GARDNER AVE. EXTENSION BEING 14.4' FROM THE CURB LINE ON THE NORTHWEST SIDE OF THE STREET AND BEING NORTHEAST 45° FROM CURB UTILITY POLE NO. 48204/52851.

**1 MILE:** A MAG NAIL PAINTED GREEN SET AT THE CURB ON THE NORTH SIDE OF 122 EAST MAIN STREET BEING SOUTHWEST 31.4° FROM THE SW CORNER 119-123 EAST MAIN ST., A BRICK BUILDING.

**2 MILE:** A MAG NAIL PAINTED GREEN SET AT THE SOUTHWEST CURB LINE MARKING A PAINT LINE NEAR THE CENTERLINE OF 236 EAST MAIN STREET, BEING 30.5° FROM THE NORTH CORNER OF A YELLOW VINYL SIDED BUILDING AT 242 EAST MAIN.

**3 MILE:** A POINT ON THE INSIDE OF LANE ONE OF THE NEW TRACK AT THE MIDDLETOWN HIGH SCHOOL, BEING 19.5' MEASURED SOUTHWEST OF THE INTERSECTION OF THE 25 YARD LINE ON THE SOUTHEAST END OF THE FOOTBALL FIELD WITH LANE ONE OF THE NEW TRACK.

**FINISH:** A YELLOW TRIANGLE ON THE INSIDE EDGE OF LANE ONE OF THE NEW HIGH SCHOOL TRACH DIRECTLY ACROSS FROM THE CENTERLINE OF THE BLEACHERS.

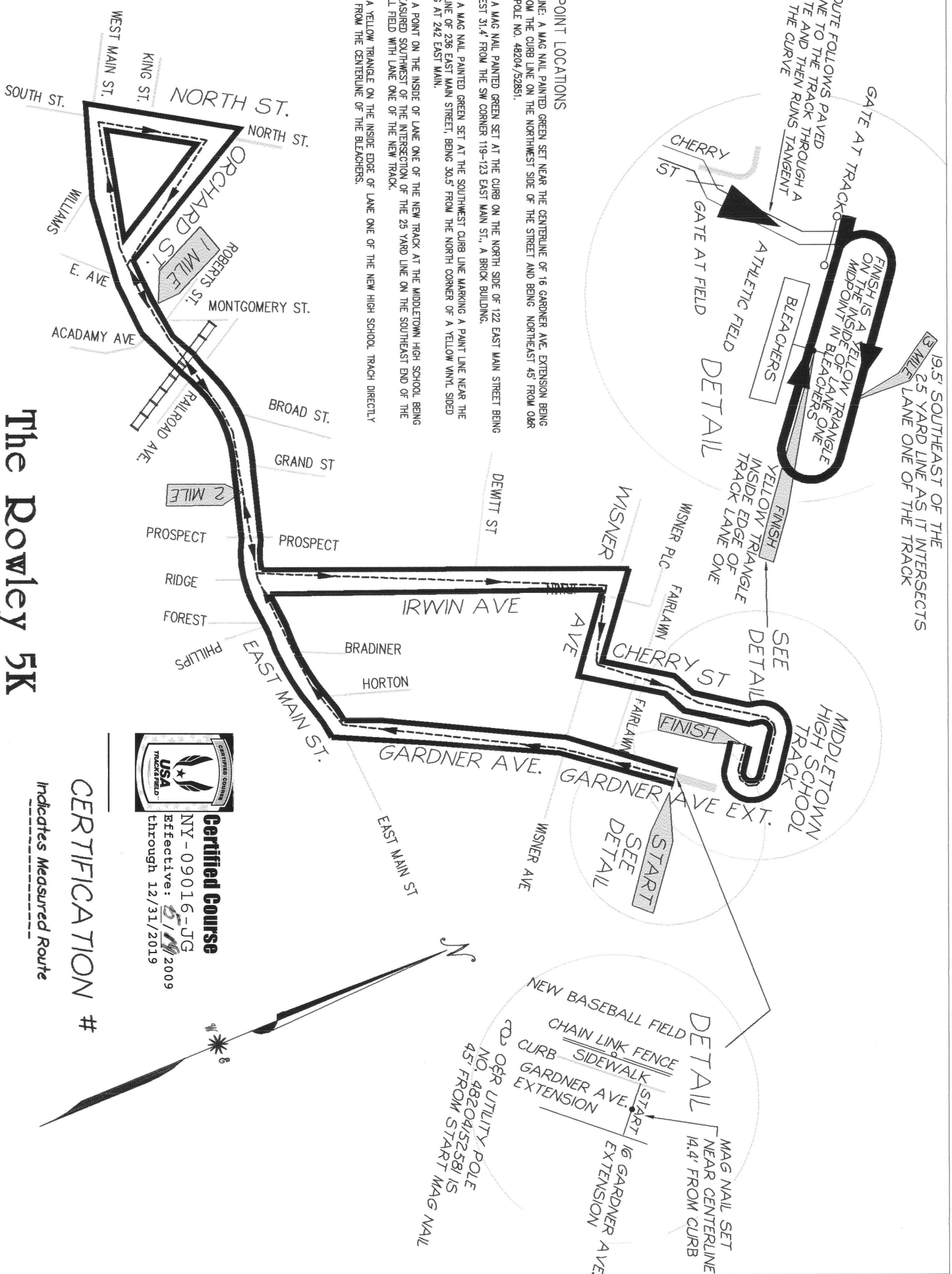

19.5' SOUTHEAST OF THE 25 YARD LINE AS IT INTERSECTS 3 MILE LANE ONE OF THE TRACK

FINISH IS A YELLOW TRIANGLE ON THE INSIDE OF LANE ONE MIDPOINT IN BLEACHERS

SEE DETAIL YELLOW TRIANGLE INSIDE TRACK LANE ONE

SEE DETAIL START

DETAIL  
MAG NAIL SET NEAR CENTERLINE 14.4' FROM CURB  
16' GARDNER AVE. EXTENSION  
START  
CURB SIDEWALK CHAIN LINK FENCE  
NEW BASEBALL FIELD  
GARDNER AVE. EXTENSION  
NO. 48204/52581 IS 45° FROM START MAG NAIL

SEE DETAIL

SEE DETAIL

SEE DETAIL

SEE DETAIL

SEE DETAIL

SEE DETAIL

SEE DETAIL